

TYPICAL SOLID SHAFT

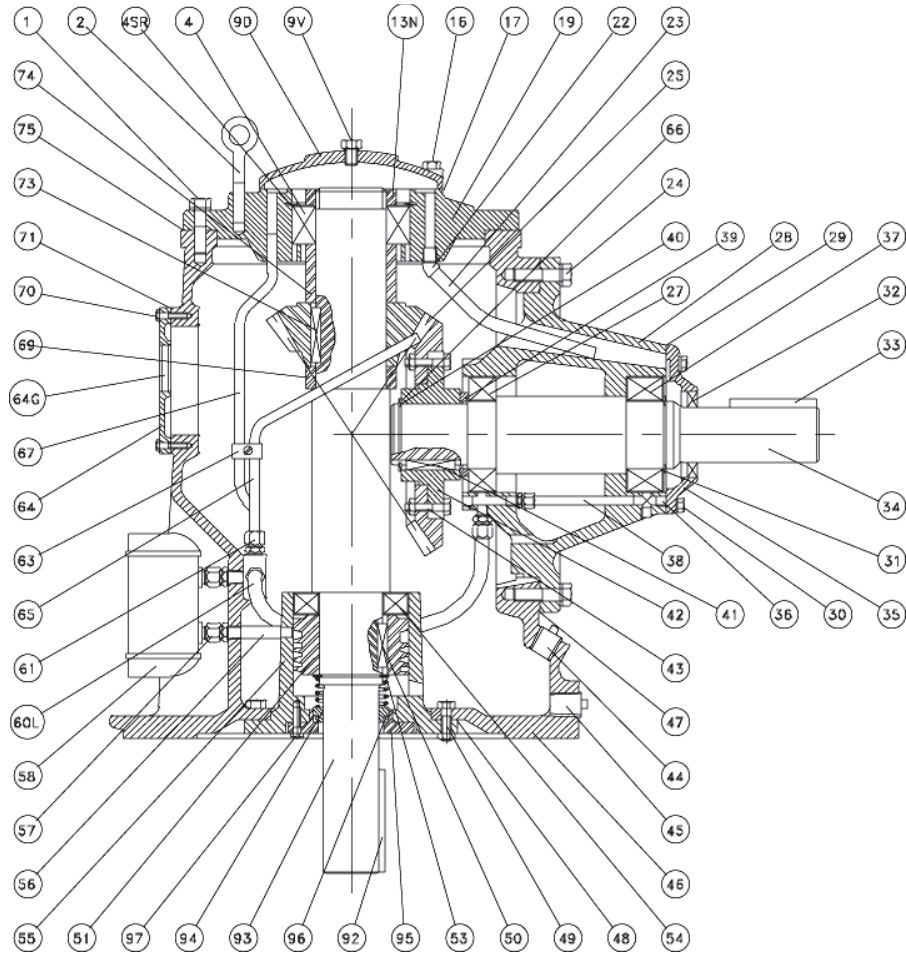

N o .	Part Name	N o .	Part Name	N o .	Part Name
1	Capscrew	36	Pipe Plugs-Hollow Head	*60L	Oil Tube To Inner Bearing
2	Lifting Eyebolt	37	Outer Bearing	*61	Compression Fittings
*4SR	Thrust Bearing Internal Snap Ring	*38	Oil Tube to Outer Bearing	*63	Clamp Assembly (Oil Tubes)
4	Thrust Bearing	*39	Gear Spacer	64	Inspection Plate
9D	Thrust Bearing Dome	40	Shim	*64G	Oil Sight Glass
9V	Vent Plug	41	Key	65	Oil Tube To Gears
13N	Locknut & Lockwasher	*42	Drive Gear Hub	66	External Snap Ring or Locknut & Washer
16	Capscrew	*43	Capscrew	67	Oil Tube To Thrust Bearing
17	Gasket-Thrust Bearing Dome	44	Pipe Plug	*69	Driven Gear Spacer
19	Thrust Bearing Cage	45	Pipe Plug	70	Capscrew
*22	Flexible Tube Fitting	46	Main Housing	71	Gasket-Inspection Plate
*23	Flexible Tube	47	Shim-Horizontal Housing	73	Key
24	Capscrew	48	Gasket-Pump Housing	74	Pinion Spacer
25	Gears	49	Capscrew	75	Shim-Thrust Bearing Cage
27	Inner Bearing	50	Key	92	Key
28	Horizontal Housing	51	Pump Runner	93	Vertical Shaft
29	Gasket-Horizontal Housing Cover	53	External Snap Ring	94	Mechanical Seal
30	Capscrew	54	Pump Bearing	95	Seal Cage
31	Snap Ring & Washer	*54W	Pump Bearing Spacer (Fig. 2 or 3)	*96	"O" Ring
32	Oil Seal	*55	Pump Housing	*97	Capscrew
33	Key	*56	Oil Tube From Pump		
34	Driveshaft	*57	Cooler Flexible Fittings		
35	Horizontal Housing Cover	*58	Oil Cooler		

* These parts are not universal and are omitted in certain ratios and models.